



9 Birnam Square, Maidstone, ME16 8UN

Spacious and well presented 3 story town house set within a quiet cul-de-sac on the outskirts of Maidstone town centre. Driveway parking and rear paved courtyard garden. Entrance porch, hall with storage, sitting room and kitchen/breakfast room. Four double bedrooms and one single bedroom with two family bathrooms.

Available late February, unfurnished, £1850 per calendar month.

£1,850 Per Month

Ground Floor

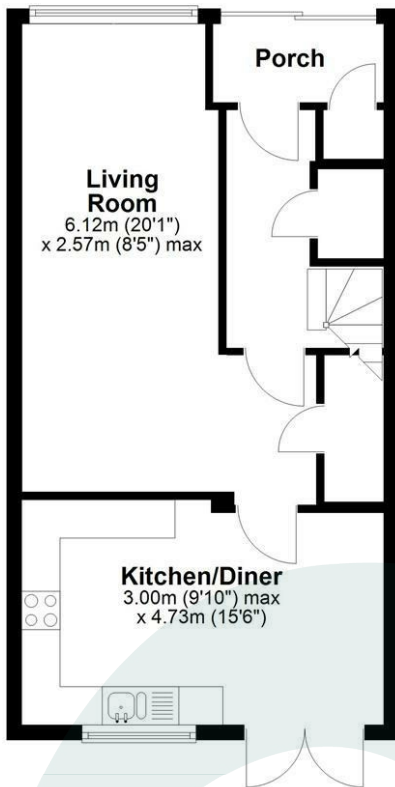

First Floor

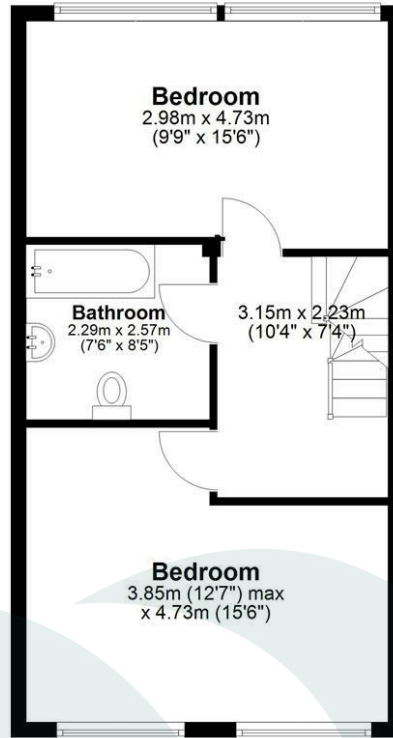

Second Floor

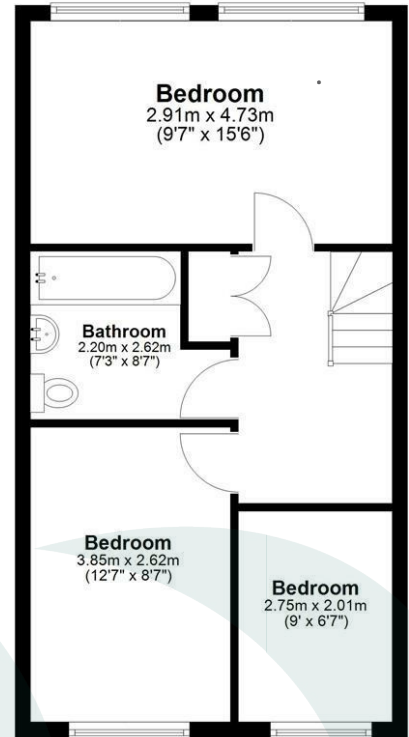

Total area: approx. 130.5 sq. metres (1404.8 sq. feet)

Energy Efficiency Rating		Current	Potential
Very energy efficient - lower running costs			
(92 plus) A			
(81-91) B			
(69-80) C			
(55-68) D			
(39-54) E			
(21-38) F			
(1-20) G			
Not energy efficient - higher running costs			
England & Wales		EU Directive 2002/91/EC	

Environmental Impact (CO ₂) Rating		Current	Potential
Very environmentally friendly - lower CO ₂ emissions			
(92 plus) A			
(81-91) B			
(69-80) C			
(55-68) D			
(39-54) E			
(21-38) F			
(1-20) G			
Not environmentally friendly - higher CO ₂ emissions			
England & Wales		EU Directive 2002/91/EC	